

Legend

- Wood**
 - Log edging for flower beds (see Detail 1)
 - "Wacky posts" (see Detail 6)
 - Logs (for seating & retaining edges of beds & sand)
 - Log seats (see Detail 4)
 - Raised vegetable planters (see Detail 7)
- Stone**
 - Flagstone or hand-made concrete stepping stones (flat, at grade with lawn/mulch)
 - Stone steps (even surface, max. 8" riser)
- Accent rocks** (max. 18" high, size varies with availability of rocks)
- Limestone screenings trail** (see Detail 2)
- Other**
 - Hill slide with wooden top landing (see Photo 6 on planting plan, final slide size & hill height to be determined by product price & availability)
 - Concrete "tunnel"
 - Planting beds (see Planting Plan for species information)
 - Mulch (fine shredded bark mulch, 30 cm depth)
 - Sand (sand box grade sand, 30 cm depth)

NOTE 1: DRAINAGE
On-site drainage currently occurs via infiltration into the playground surface (turf). Post-construction drainage and stormwater control will continue to rely on infiltration. Due to the reduced porosity of the stonedust paths, these surfaces should have a cross-slope draining towards the adjacent turf areas, or mulch areas if applicable.

NOTE 2: SLIDE
Slide orientation is west. Concerns regarding late afternoon sun exposure on south and west-facing play surfaces have been addressed through plantings of trees on the south and east boundaries of the play area. Existing 10m tall Sugar Maple located to the west of the proposed slide will also provide afternoon shade.



Area and Volume of Materials on Plan

Planting	Area (m ²)	Volume of topsoil required (m ³) (20cm depth)
P1	3.5	0.7
P2	1.25	0.25
P3	2	0.4
P4	7.5	1.5
P5	38	7.6
P6	3.5	0.7
P7	1	0.2
P8	6	1.2
P9	32	6.4
P10	1.25	0.25
P11	1.25	0.25
TOTAL	55.25	11.1

Trail	Area (m ²)	Volume of screenings required (m ³) (5 cm depth)
L1	33	0.65
L2	44	0.88
L3	35	0.7
TOTAL	92	4.6

Trail	Area (m ²)	Volume of gravel required (m ³) (7.5 cm depth)
L1	33	0.975
L2	44	1.32
L3	35	2.625
TOTAL	92	6.9

Sand	Area (m ²)	Volume of sand required (30cm depth)
S1	5.75	1.73
S2	10	3
TOTAL	15.75	4.7

Mulch	Area (m ²)	Volume of mulch required (30 cm depth)
M1	26.5	7.95
M2	8.5	2.55
M3	2.75	0.83
M4	1.5	0.45
M5	1.5	0.45
M6	22	6.60
TOTAL	62.75	18.8

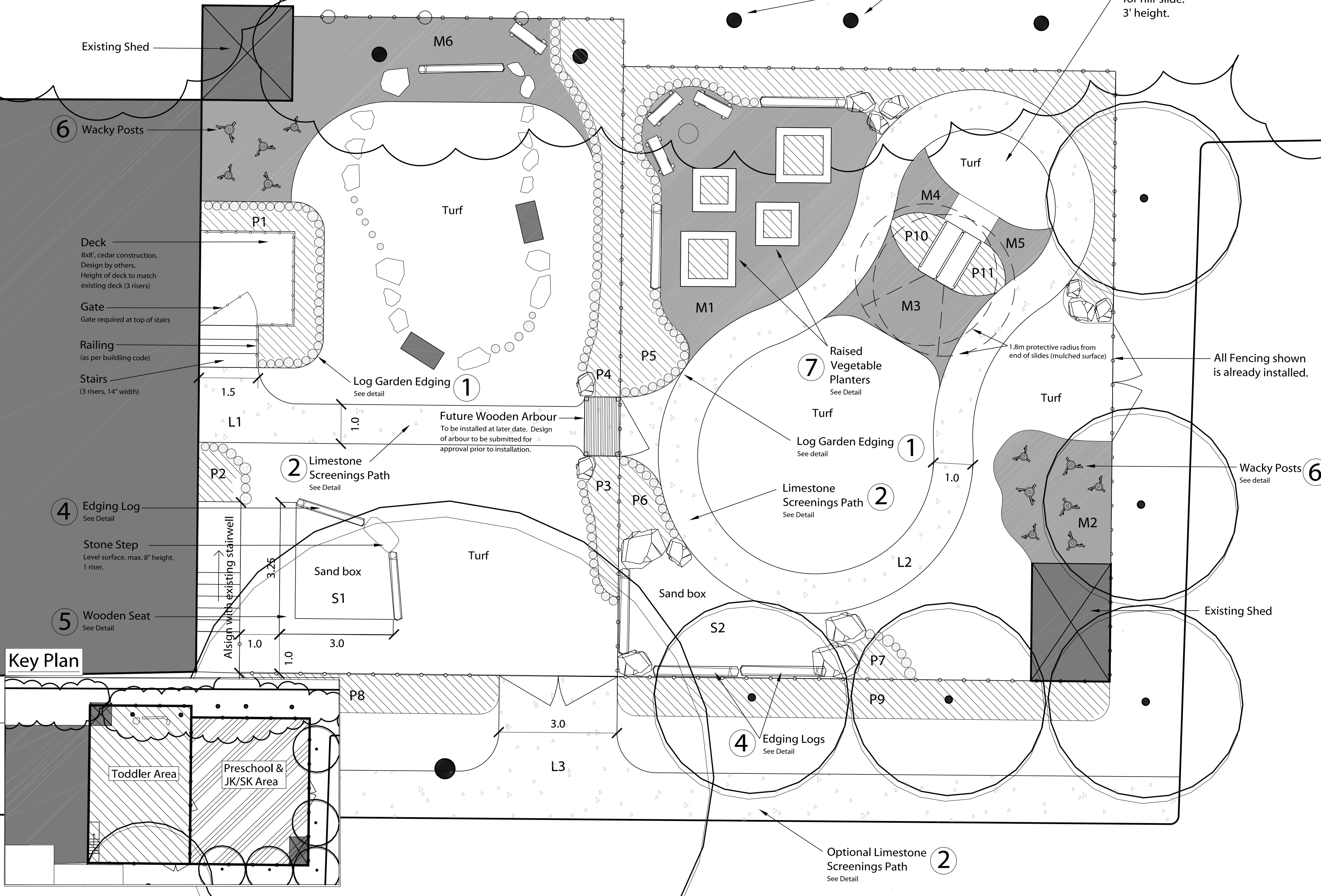

5. Sandbox Seat

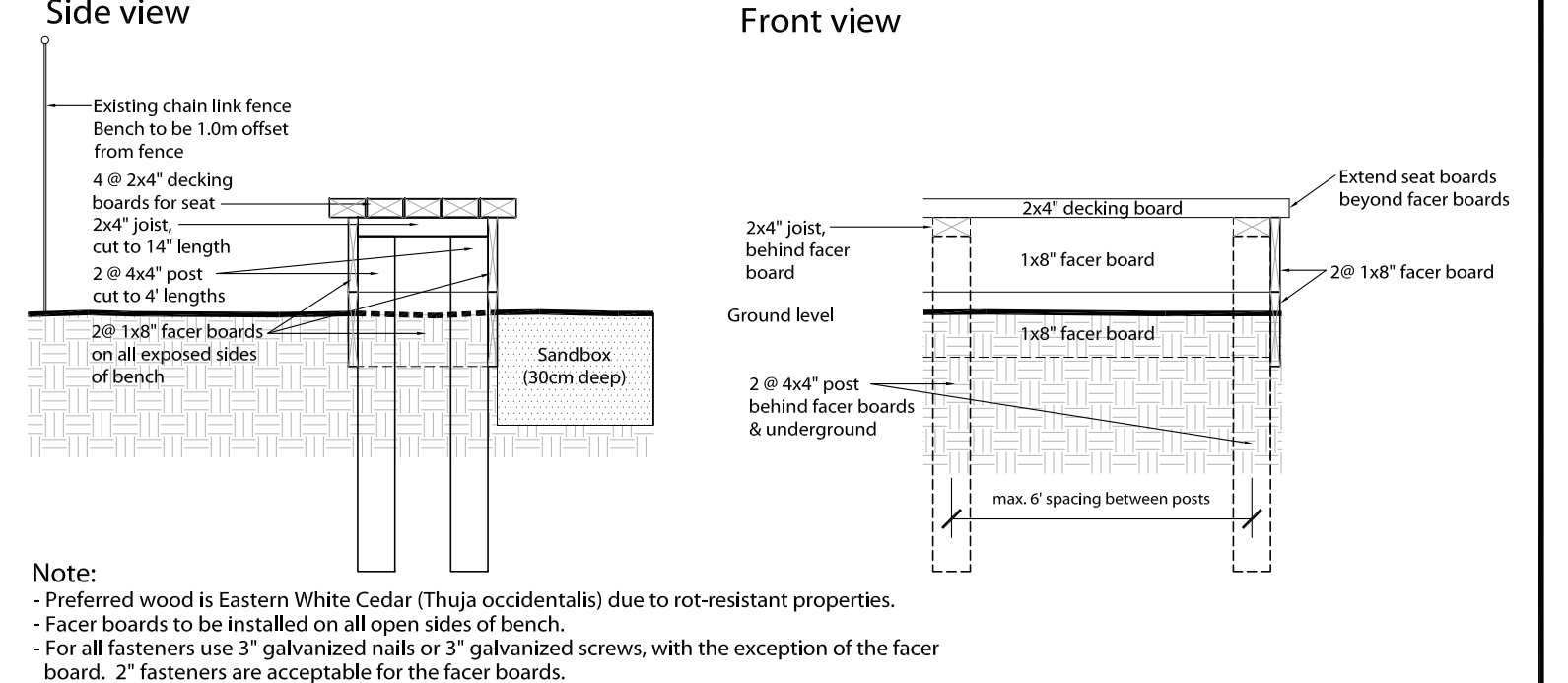

Note:
- Preferred wood is Eastern White Cedar (*Thuja occidentalis*) due to rot-resistant properties.
- Facer boards to be installed on all open sides of bench.
- For all fasteners use 3" galvanized nails or 3" galvanized screws, with the exception of the facer board. 2" fasteners are acceptable for the facer boards.

6. Wacky Posts

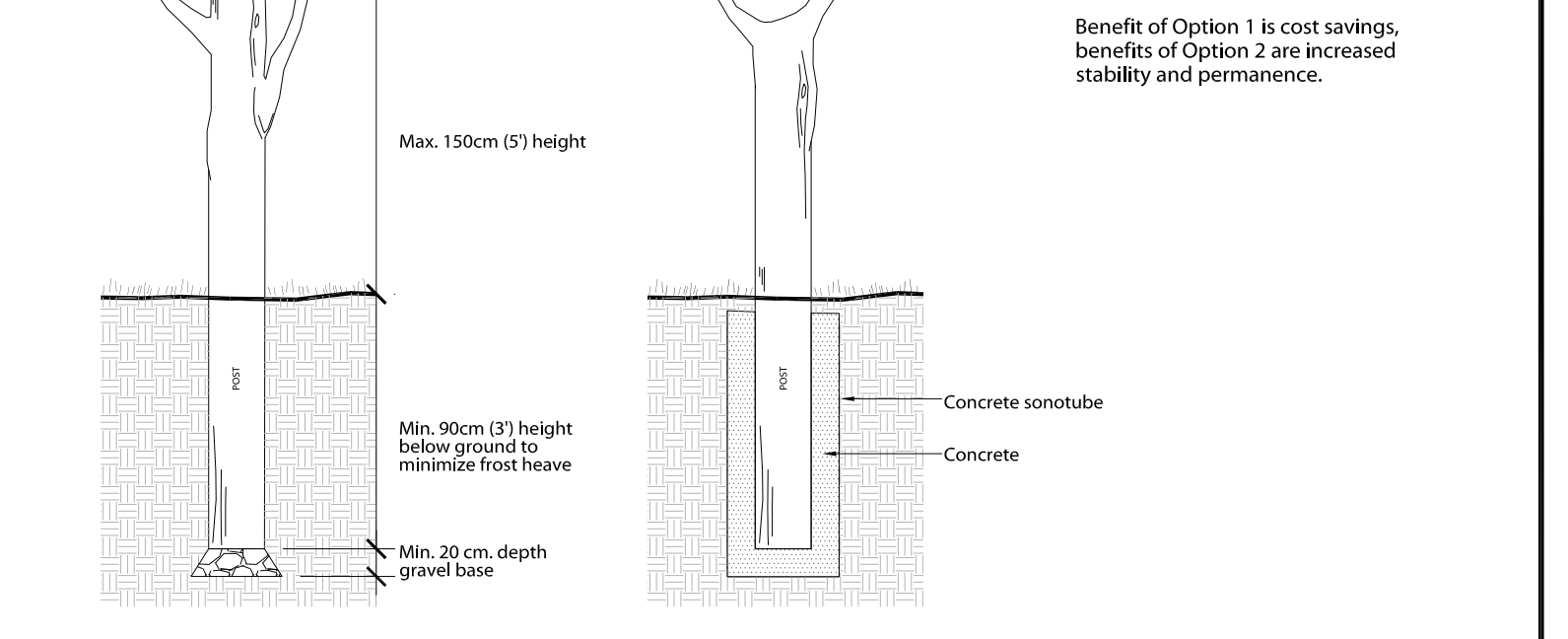

Notes:
- Preferred wood is Eastern White Cedar (*Thuja occidentalis*) due to rot-resistant properties.
- Benefit of Option 1 is cost savings, benefits of Option 2 are increased stability and permanence.

7. Vegetable Garden Plots

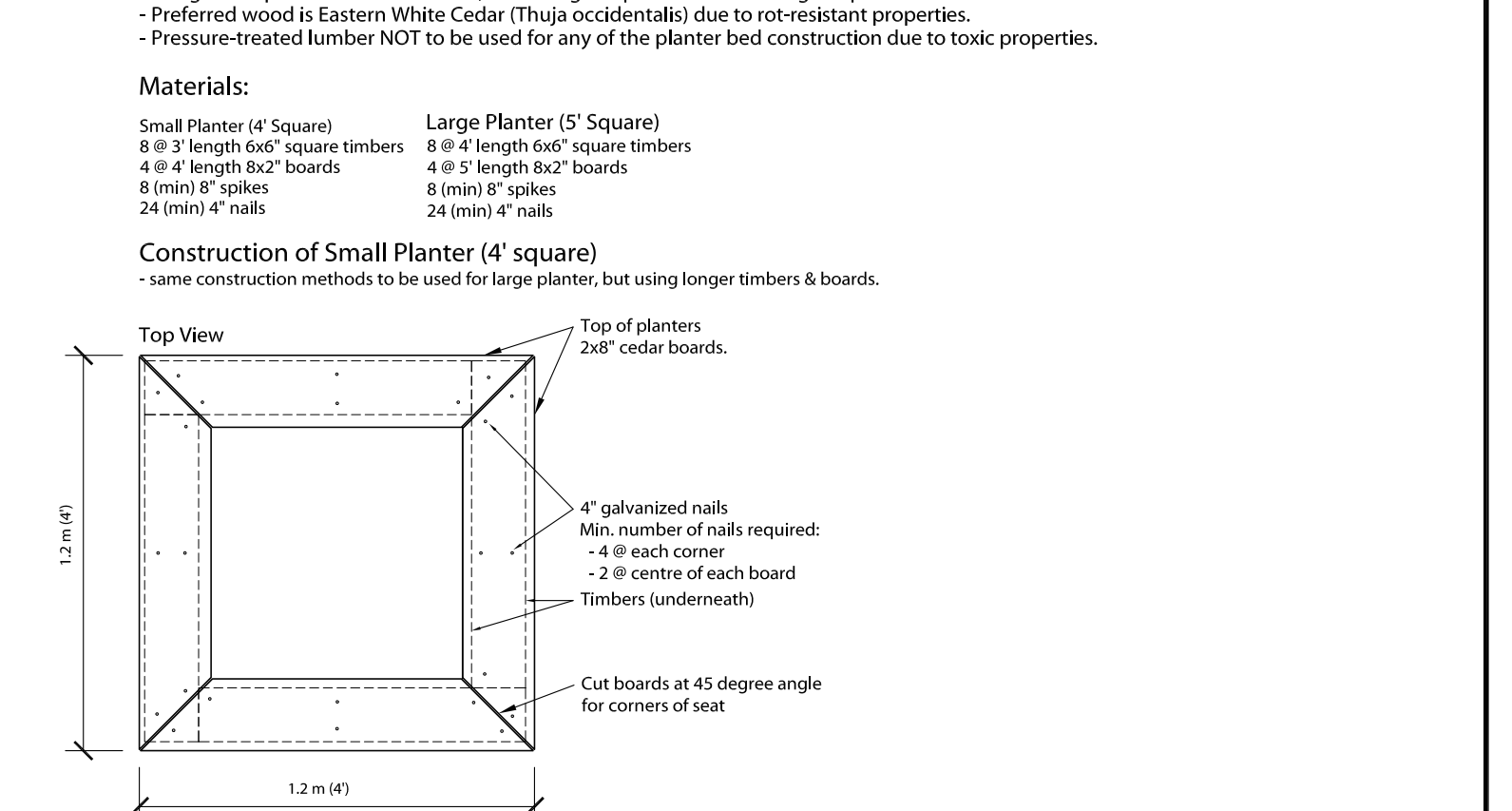

Construction of Small Planter (4' square)
- same construction methods to be used for large planter, but using longer timbers & boards.

1. Garden Log Edging

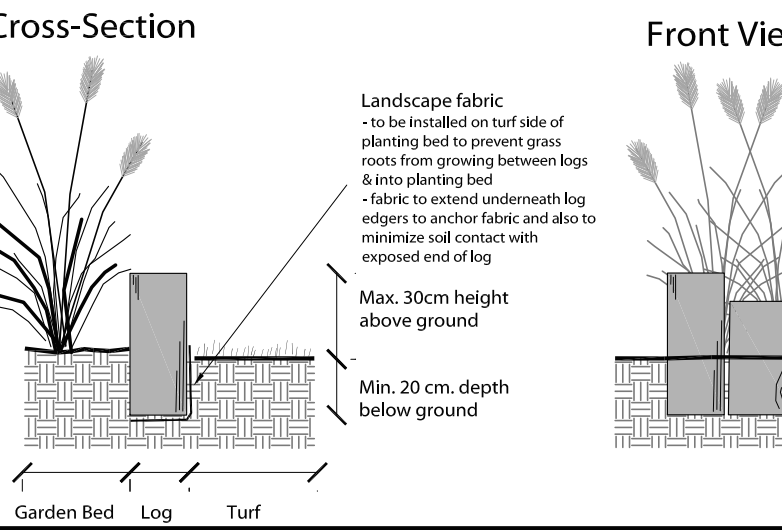

2. Limestone Screenings Path

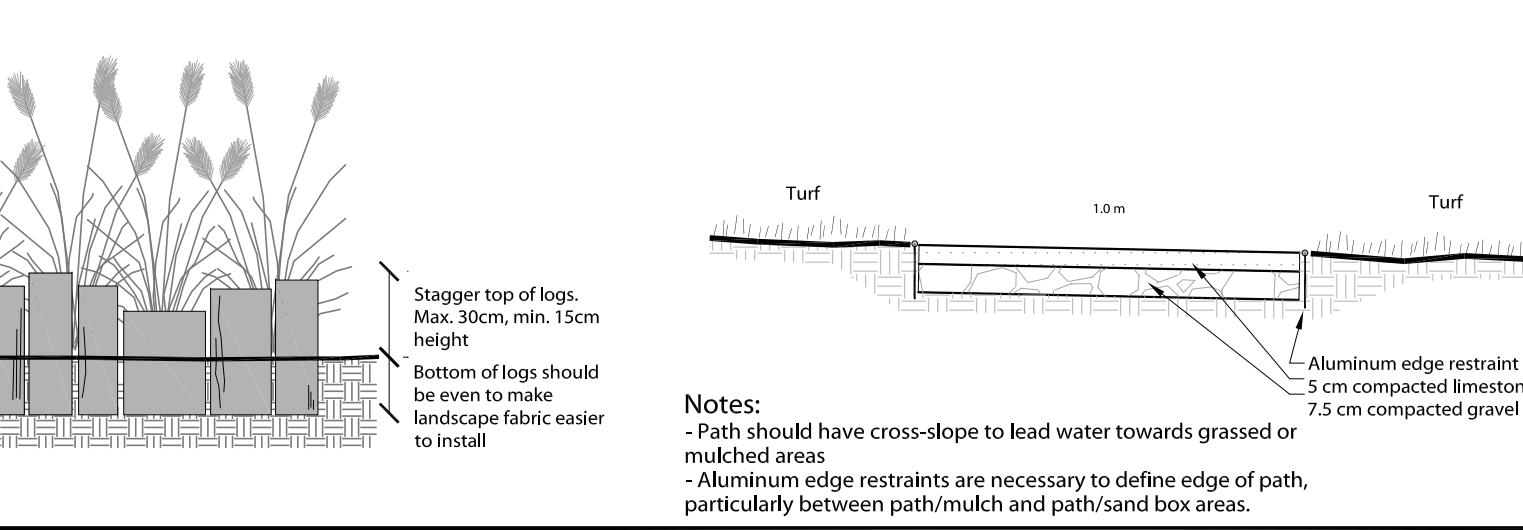

3. Sandbox Edging Logs

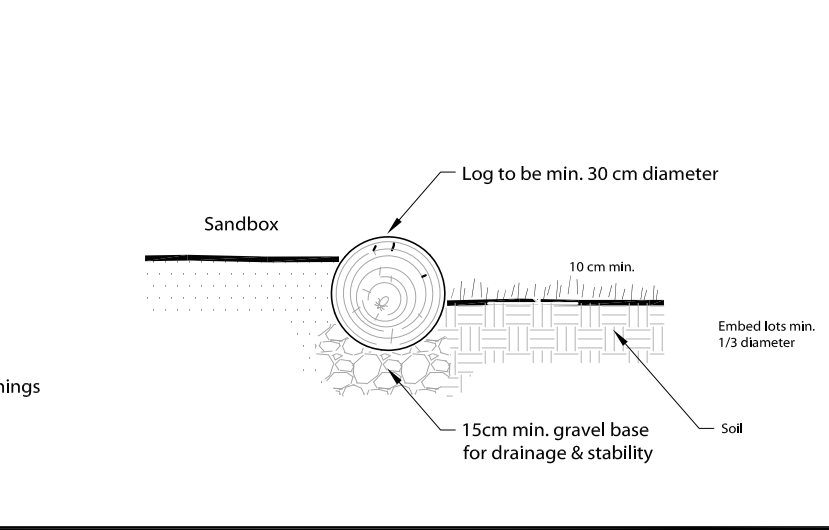

4. Log Seat

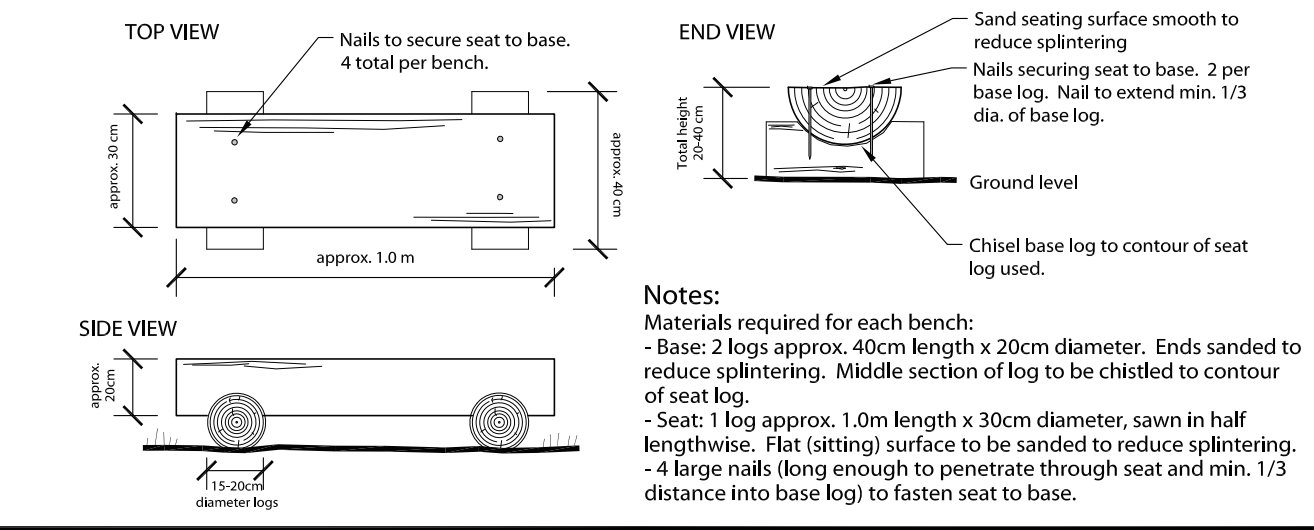

77 Wyndham Street South • Guelph ON N1E 5R3
T 519.822.1609 • F 519.822.5389 • www.dougan.ca

FIRST STEPS DAYCARE NATURAL PLAYGROUND DESIGN LAYOUT PLAN

NOT ISSUED FOR CONSTRUCTION. FOR INFORMATION AND APPROVALS PURPOSES ONLY.
Client: First Steps Daycare Project: DA10-018-01
Date: 2010-06-01
Scale: VARIES
Drawn By: MAY
Checked By: TF